

FOR LEASE

738 W. 22nd Street, Suite 10 ♦ Norfolk, VA 23517

Area Demographics*:

Population: 65,567
Median Age: 32
Median Income: \$47,800
Avg. Income: \$80,054



1,200 SF

Excellent Location
with 21st Street Visibility

Located in The Center Shops, a 131,309 square foot shopping center. Surrounded by such retailers as Panera Bread, Tropical Smoothie, Hot House Yoga, Luna Maya, and Vitamin Shoppe.

**Demographic information compiled by zip code*

Contact:

Stewart Buckle: sbuckle@morganregroup.com
Michelle O'Keefe: mokeefe@morganregroup.com

223 E. City Hall Avenue, Ste 214 • Norfolk, VA 23510
Phone: (757) 625-2595 • Fax: (757) 625-4001
www.morganregroup.com

Space Plan

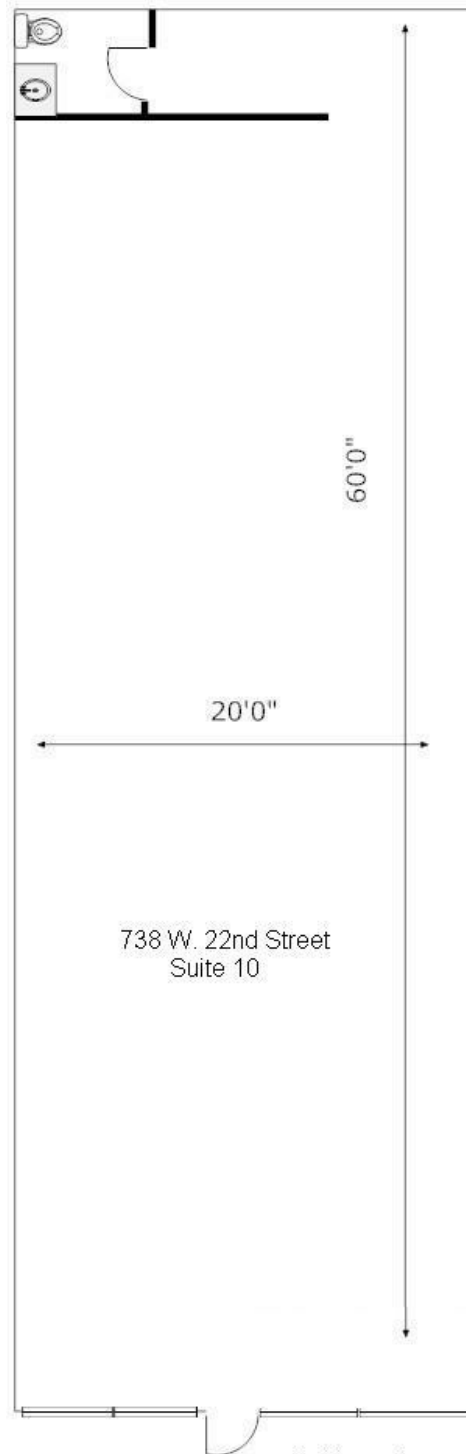

The Center Shops Site Plan

ROSEMYR CORPORATION

